

SCG-401K Grid System

Installation Guide

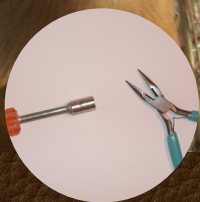

SCG-401K

Installation Guide

The SCG-401K Kit includes

- One SCG-401K Grid
- Two plastic acorn nuts
- Two 6-32/6-32 stainless steel inserts
- Two 6-32/4-40 stainless steel threaded stud
- Basic installation instructions

Tools Needed: 1 pliers (needle nose pliers), 5/16" nut driver and a flat blade screwdriver (optional).

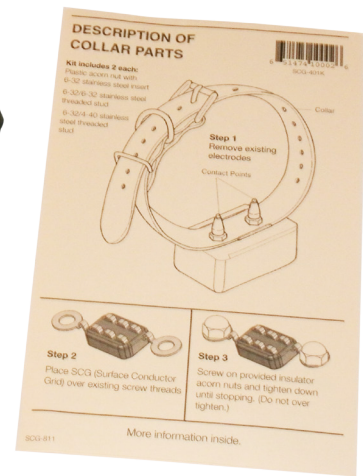

Step 1: Remove the contact points.



- A. The contact points on some receivers are screwed on, and some are screwed in.
- B. If the contact points are screwed on then the studs will remain on the receiver, as in the example.
- C. If the studs come off with the contact points then use the appropriate studs that are provided. There are two sizes provided.

Step 2: Form the SCG-401K to fit on the receivers studs.

- A. The SCG-401K may fit the receiver without any adjustments.
- B. You may have to use the pliers to bend and stretch the eyelet to make the SCG-401K fit.



Step 3: Once the SCG-401K fits over the Studs you can place insulated acorn nut and tighten.



Step 4: Adjusting the height of the SCG-401K is simple.

- A. Put the grid on the studs and place the insulated nuts on one turn.
- B. Slide a flat blade screwdriver blade between the SCG-401K and the housing.
- C. Tighten the nuts. Note: the height of the SCG-401K is determined by the thickness of the Screwdrivers blade.